

CERTIFIED RECORD OF LAND CORNER MONUMENTATION

History of original corner establishment:

None

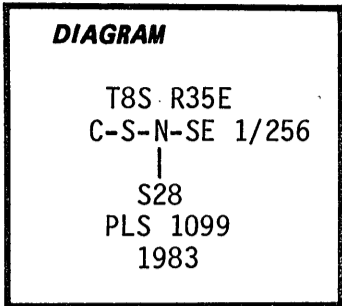

Description of corner evidence found:

None

Found unrecorded pin  
8.6 ft. South  
5.2 ft. West

Description of monument and accessories I established to perpetuate the original location of this corner:

At the corner position determined by survey set a 2 1/2"x30" galv. iron pipe with brass cap 29" in ground with raised mound of stone marked:

From which:

A Lodge Pole Pine 5" dia. bears N85°E 12.5 ft. marked X BT

A Tamarack 15" dia. bears S12°W 58.5 ft. marked CSNSE 1/256 S28 BT

T8S R35E  
C-S-N-SE 1/256  
|  
S28  
PLS 1099  
1983

Attached brass washers stamped LS 1099 to BT blaze on both trees.

Corner perpetuated in accord. with Umatilla N.F. Survey Contract No. 53-04R3-2-01275.

20°E Declination  
Steel Tape

Post East W/54-2  
Post North W/54-2 & 54-9

Corner in Lodge Pole thicket 300' from creek

Sept. 1, 1983

Witnesses: A. Ray Crapo  
Greg Orton  
Kyle McKinney

Refer to Grant County Survey No. 828

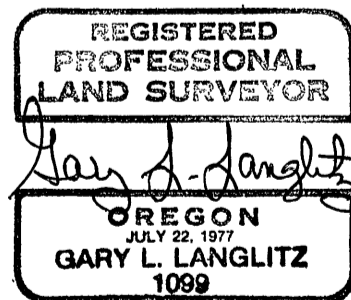

Office of SURVEYOR County of GRANT

State of OREGON, I hereby certify that the within instrument was filed in this office

for record on the 30 day of AVG, 1984

Robert P. Dwyer by \_\_\_\_\_  
(COUNTY OFFICIAL) (DEPUTY)